

## Chukyo University, Toyota Campus, No.5 Building (Small Gymnasium)

Address	No. 5 Building, 101, Tokodachi, Kaidu-Cho, Toyota City, Aichi Prefecture			
Size and specifications	<b>Gymnastic area</b>			
	Area: 864 m <sup>2</sup> (24 m x 36 m). Ceiling height: 6.7 m. Equipped with a pit for gymnastics Video room is installed.			
	Floor for floor exercise	Circle area	Parallel bars: 2	Balance beams: 2
	Balance beams: 2	Space for rings	Horizontal bar	Trampoline
	Pommel horse: 2	Vaulting horse	Uneven parallel bar	
Completed	1971 (Gymnastic area was renovated in 2007)			
Parking spaces	866 cars			
Affiliated facilities	<b>In the No. 5 Building</b>		<b>In the Campus</b>	
	Shower: 1 unit Locker room: 1 each for men and women Free Wi-Fi		Conference room Dispensary Restaurant (Café)	
	Weight training room			
Website	<a href="http://www.chukyo-u.ac.jp/english/">http://www.chukyo-u.ac.jp/english/</a>			



The gymnasium satisfies requirements of international standards.

# Chukyo University Toyota Campus, No.5 Building Small Gymnasium

### ACCESS

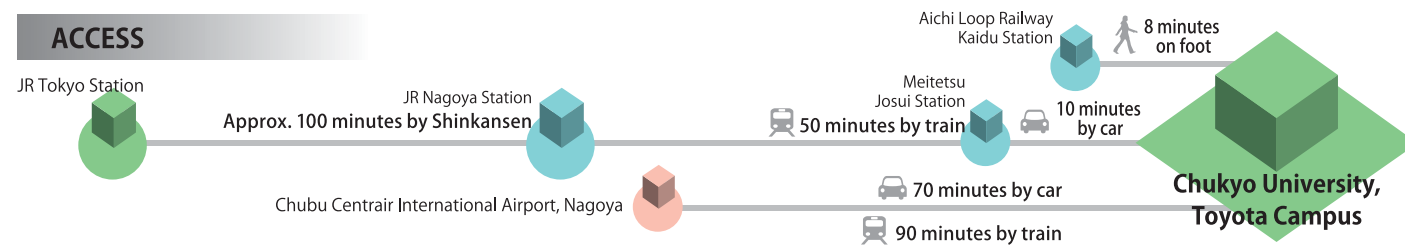

### Accommodations in the vicinity

#### Hotel Toyota Castle

Address	COMO Square West, 160 2-Chome, Kita-machi, Toyota City, Aichi Prefecture		
Capacity	205 people	Restroom	Western-style restroom
Completed	2006		
Number of rooms	89 single-bed rooms, 8 deluxe grade single-bed rooms, 29 twin-bed rooms, 8 deluxe grade twin-bed rooms, 14 double-bed rooms, 2 suite rooms, 1 castle suite room		
Facilities, services	Buffet style, lunch box (bento) style, Vegetarian diet, Decaffeinated and non-alcoholic beverages, and Hypoallergenic food are available. Conference room, Banquet room, Parking spaces, Roombath, Multi-functioned restroom, International broadcasts, International telephone, Wi-Fi, Foreign currency exchange, Information service, Cleaning		
Distance from training facility	5.9 km	Foreign language support	English
Website	<a href="http://www.t-castle.co.jp/english/">http://www.t-castle.co.jp/english/</a>		

#### Meitetsu Toyota Hotel

Address	1-140, Kita-machi, Toyota City, Aichi Prefecture		
Capacity	135 people	Restroom	Western-style restroom
Completed (renovated)	1995		
Number of rooms	57 single-bed rooms, 18 twin-bed rooms, 4 deluxe grade single-bed rooms, 7 deluxe grade twin-bed rooms, 6 double-bed rooms, 1 deluxe grade double-bed room, 1 bridal room, 2 suite rooms, 1 multi-purpose room		
Facilities, services	Buffet style and Hypoallergenic food are available. Conference room, Banquet room, Parking space, Roombath, Multi-functioned restroom, International broadcasts, International telephone, Wi-Fi, Foreign currency exchange, Cleaning		
Distance from training facility	5.7 km	Foreign language support	English
Website	<a href="http://www.toyota-hotel.co.jp">http://www.toyota-hotel.co.jp</a>		

#### Hotel FORESTA

Address	1-1, Ipponmatsu, Iwakura, Toyota City, Aichi Prefecture		
Capacity	87 people	Restroom	Western-style restroom
Completed	1994 (2010)		
Number of rooms	26 twin-bed rooms, 3 Japanese-style rooms, 2 suite rooms	Training facilities	Training room, Pool, Sauna room, Massage room
Other facilities, services	Lunch box (bento) style, Halal, Kashrut, Vegetarian diet, Decaffeinated and non-alcoholic beverages, and Hypoallergenic food are available. Conference room, Banquet room, Parking spaces, Roombath, Common bath, Multi-functioned restroom, International broadcasts, International telephone, Wi-Fi, Foreign currency exchange, Information service, Cleaning, Coin-laundry		
Distance from training facility	11.4 km	Foreign language support	English
Website	<a href="http://www.forestahills.jp">http://www.forestahills.jp</a>		

### Toyota City sightseeing spots, attractions



Toyota Municipal Museum of Art



Obara Paper Art Museum, "Washi no Furusato"



Korankei

Sports Section, Chukyo University

TEL +81-565-46-6935

\*Only Japanese available.

E-Mail [sports@mng.chukyo-u.ac.jp](mailto:sports@mng.chukyo-u.ac.jp)

Information on the sports facilities in Aichi

Aichi Sports Commission <http://aichi-sc.jp/>

※The information listed on this leaflet is as of July, 2016, and is subject to change without notice.

Toyota City, Aichi Prefecture

Pre-game training camp/Suggested Sports

Gymnastics artistic





## Gymnastic area

Area 864 m<sup>2</sup>

Total floor area: 864 m<sup>2</sup>, Ceiling height: 6.7 m  
 The gymnastic area is equipped with a floor for floor exercises, 2 pommel horses, a circular area, rings, a vaulting horse, 2 sets of parallel bars, a horizontal bar, one set of uneven parallel bars, 2 balance beams and a trampoline.  
 Furthermore, the gymnastic area was renovated in 2007 to accommodate exercise pits for rings and a bar, air-conditioning, and a video-room to study form.



### Competitions and Training camps held

Training Session for Junior Players of Toyota Gymnastics Association (annually), Chukyo Junior Cup (annually), Training camp of junior gymnastic players in Aichi Prefecture (annually)

## Floor plan of the Small gymnasium

1F

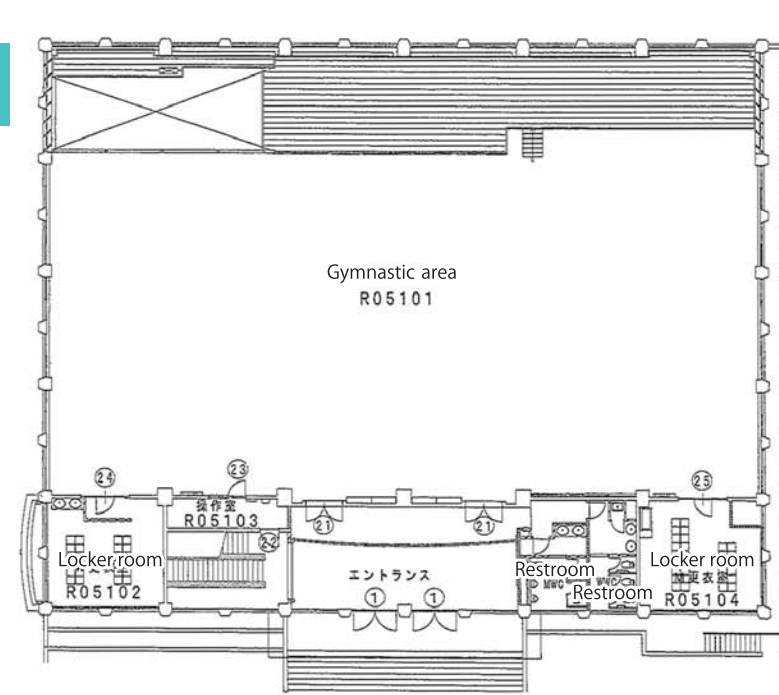

2F

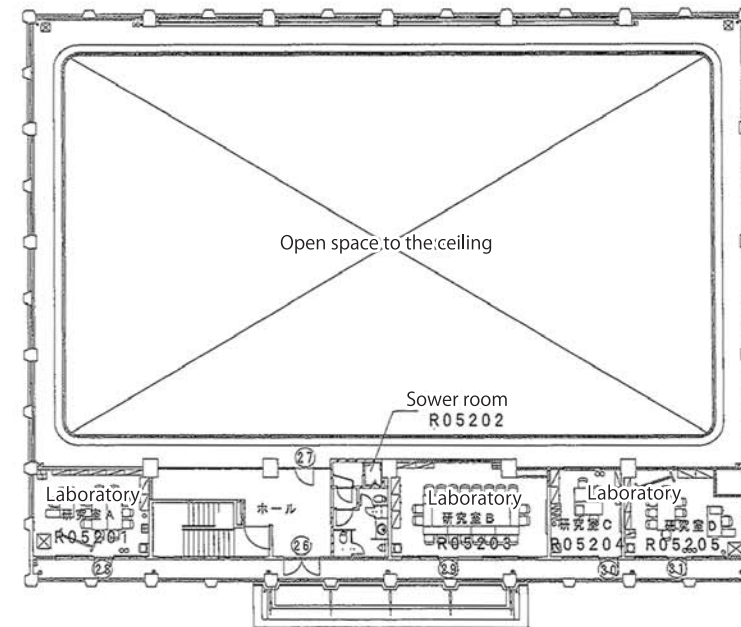

3F

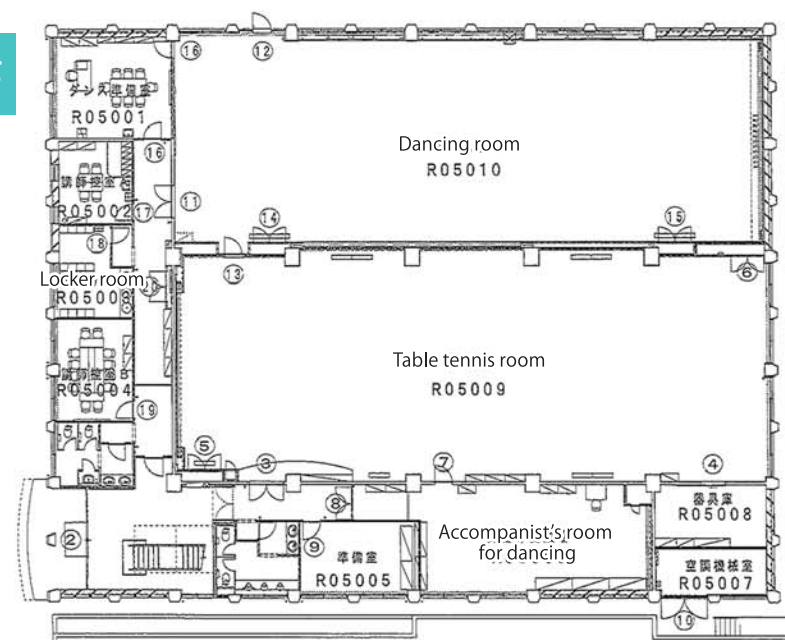

### Weight training room

In the Campus, about 30 kinds of muscle training machines for professional use, 60 units in total, are installed.

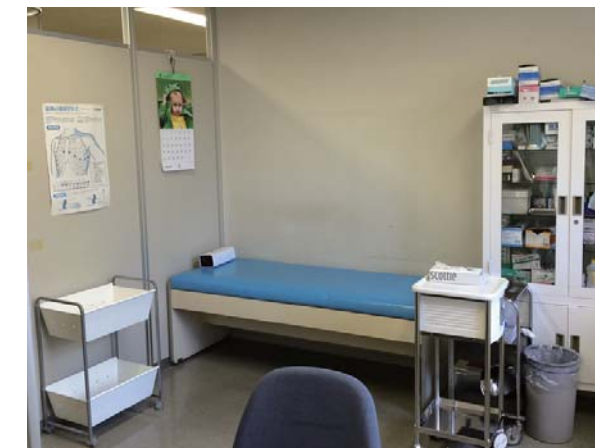

### Dispensary

A dispensary is installed in the campus.



### Locker room