

Komaki City Sports Park Gymnasium (Park Arena Komaki)

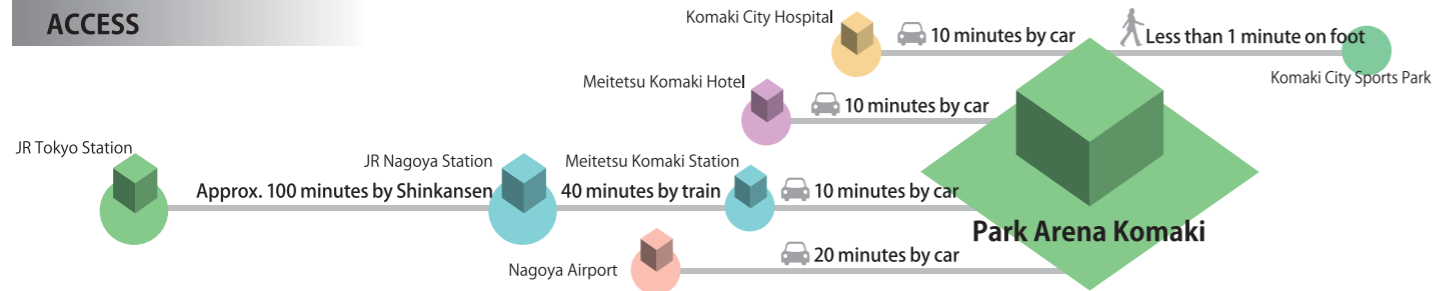

Address	737, Oaza-Mamahara-shinden, Komaki City, Aichi Prefecture
Size and specifications	Total floor area: 16,733 m ² Ceiling height: 20 m, Air-conditioned This training facility meets the requirement of National Federation of Basketball and Volleyball. Available space for 1 basketball court or 1 volleyball courts
Completed	2001
Parking spaces	637 cars (435 covered spaces), 10 large buses.
Universal design	Sloped doorways, Elevators for the disabled, Braille signs, Braille blocks, Wheelchair-accessible restrooms, Showers (Barrier-free), Locker rooms (Barrier-free), Disabled parking spaces
Affiliated facilities	4 players' waiting rooms, 2 locker/shower rooms, 3 conference rooms, Multi-functioned restrooms, Training gym
Website	http://www.ma.ccnw.ne.jp/komakipk

ACCESS



Accommodations in the vicinity

Meitetsu Komaki Hotel



Address	1-260, Chuo, Komaki City, Aichi Prefecture
Capacity	105 people (89 people excluding Japanese-style and special rooms)
Number of rooms (by type)	39 single-bed rooms, 22 twin-bed rooms, 3 double-bed rooms
Completed	1990
Parking spaces	Adjacent to the hotel, contracted multi-story car park (one car free for each room)
Foreign language support	English
Distance from training facility	3.3 km, 10 minutes by car
Website	http://www.mei-komakihotel.co.jp/en

Medical institutions in the vicinity

Komaki City Hospital

Address	1-20, Jobushi, Komaki City, Aichi Prefecture	Departments Internal Medicine, Cardiology, Gastroenterology, Respiratory Medicine, Neurology, Hematology, Nephrology, Diabetes and Endocrinology, Surgery, Neurosurgery, Cardiovascular Surgery, Thoracic Surgery, Orthopedic Surgery, Plastic Surgery, Dermatology, Obstetrics and Gynecology, Pediatrics, Urology, Otolaryngology, Rheumatology, Ophthalmology, Radiology, Psychiatry, Anesthesiology, Oral and Maxillofacial Surgery, Palliative Care, Pathological Diagnosis, Physical Therapy and Rehabilitation, Emergency and Critical Medicine
Holidays and nighttime	Emergency care available 24 hours a day	
Foreign language support	Spanish, Portuguese	
Distance from training facility	3 km, 10 minutes by car	

Sightseeing spots in the vicinity: Within 10 minutes by car from the arena

- 1. Mount Komaki (national historic site)**
It is a small mountain with an elevation of 85.9 meters above sea level. You can enjoy cherry blossoms in spring, colorful foliage in autumn, and other views according to the season. During the Sengoku Period, Oda Nobunaga first built a castle on Mount Komaki. Later, the castle became the main camp for the allies of Tokugawa Ieyasu and Oda Nobukatsu during the battle of Komaki/Nagakute.
- 2. Komaki City Historical Museum (a 15 minute walk from the parking area)**
Situated at the top of Mount Komaki. You can enjoy a 360-degree panoramic view that Oda Nobunaga and Tokugawa Ieyasu also enjoyed. In the museum, archaeological, folk and historic materials of Komaki City and a panorama model of the battle of Komaki/Nagakute are displayed.
- 3. Menard Art Museum**
This museum houses about 1,400 pieces of art that were collected by the founding couple of Nippon Menard Cosmetic Co., Ltd., including paintings by Manet, Gogh, Picasso, Yokoyama Taikan, Kishida Ryusei, as well as sculptures and crafts. You can fully appreciate about 70 excellent pieces of art in a quiet atmosphere.

Park Arena Komaki

TEL +81-568-76-1167

Office hours: Mon. through Fri. 10:00 a.m.-5:00 p.m.
*Except national holidays
*Only Japanese available.

E-Mail sports@city.komaki.lg.jp

*Only Japanese available.

Information on the sports facilities in Aichi

Aichi Sports Commission <http://aichi-sc.jp/>

※The information listed on this leaflet is as of July, 2016, and is subject to change without notice.

30 minutes from downtown Nagoya, within 10 minutes to accommodations in the city, experience in hosting international games

Park Arena Komaki

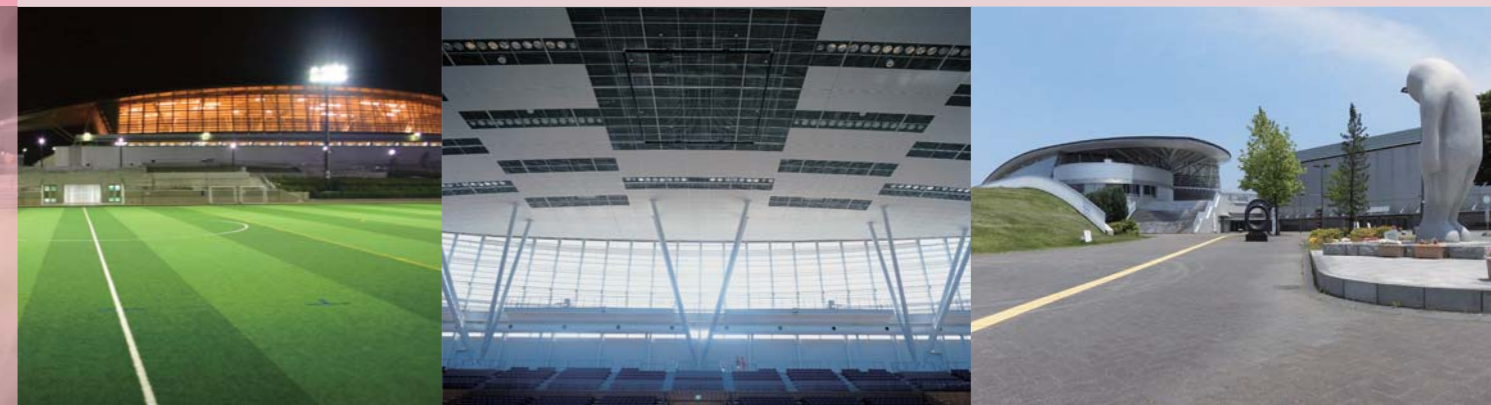

■ Komaki City, Aichi Prefecture

Pre-game training camp/Suggested Sports

Basketball, Volleyball



Area 2,600m² | Main arena

Total floor area: 2,600 m² (40m×65m), Ceiling height: 20 m,
This training facility meets the requirement of National Federation of Volleyball and Basketball.
Opening/closing type windows to take in natural light and wind, and roll type screens to block light are installed.

Park Arena Komaki

As one of the leading indoor gymnasiums in Aichi prefecture, Park Arena Komaki is a friendly and advanced facility with a barrier-free design and rain-water recycling system. Consisting of a main arena, sub arena and a training gym, the arena is well unified with nature, surrounded by lush greenery park.

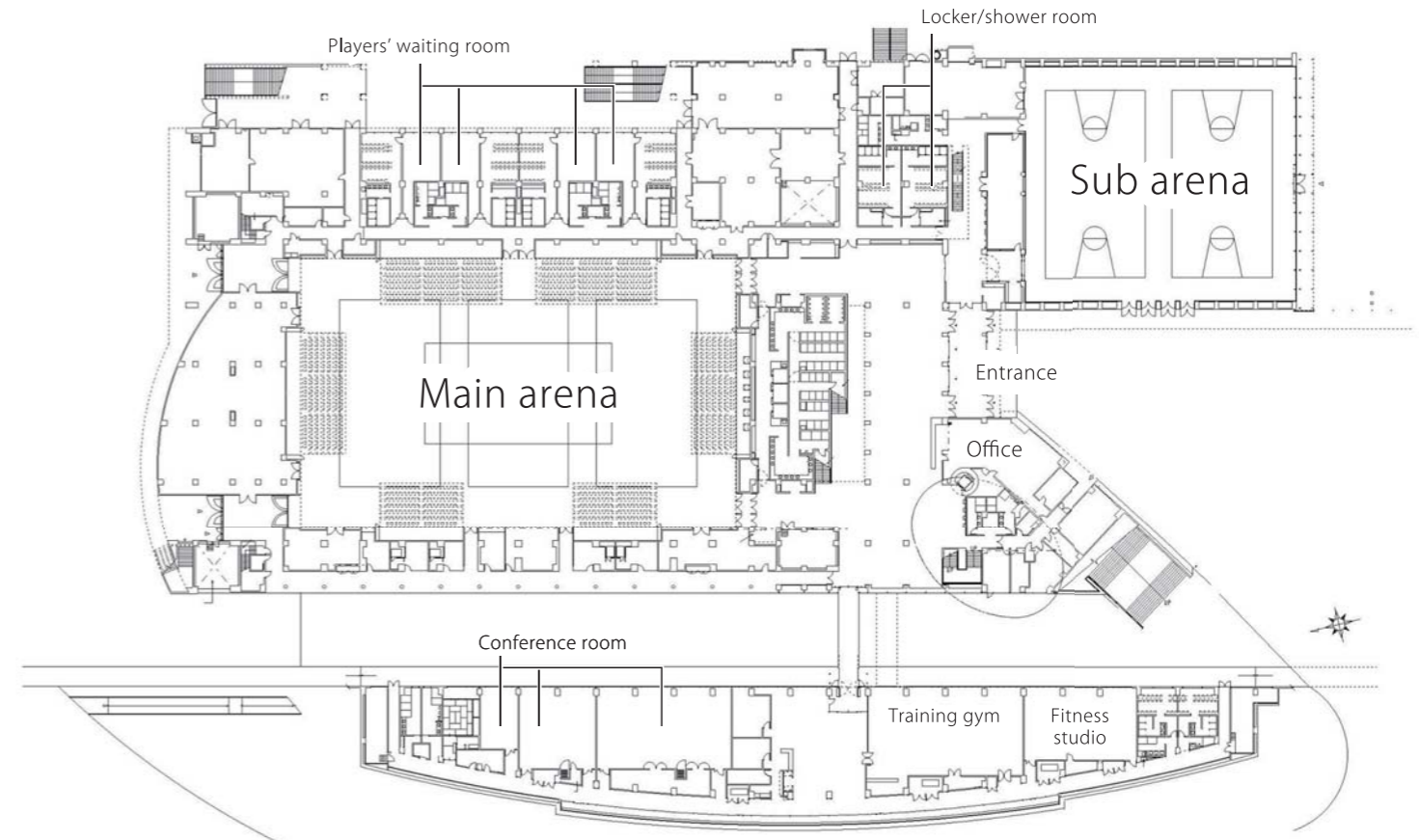

Sub arena

Total floor area: 1,400 m² (35m×40m)
Ceiling height: 13 m



International or national competitions held

FIVB Volleyball World Cup 2015, 2007 FIVB Volleyball World Grand Prix 2012 The First East Asia Basketball Championships 2009

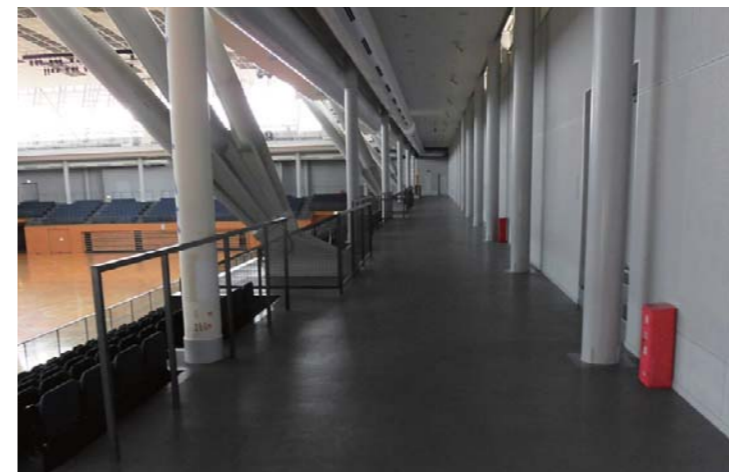

Indoor jogging course in the main arena
Track: 250 meters, most suitable for warming up



Training gym
A total of 58 machines of 32 kinds, including full-fledged muscle training machines



Conference room
Up to 88 people can be accommodated. Audio equipment, a projector and a large screen are also installed.



Players' waiting room
Four rooms are available. Each room has 96 lockers and 4 showers.



Locker/shower room
A shower room with lockers is available both for men and women. Each room has 54 lockers and 4 showers.