

## Toyota Industries Kaiyoh Yacht Harbor

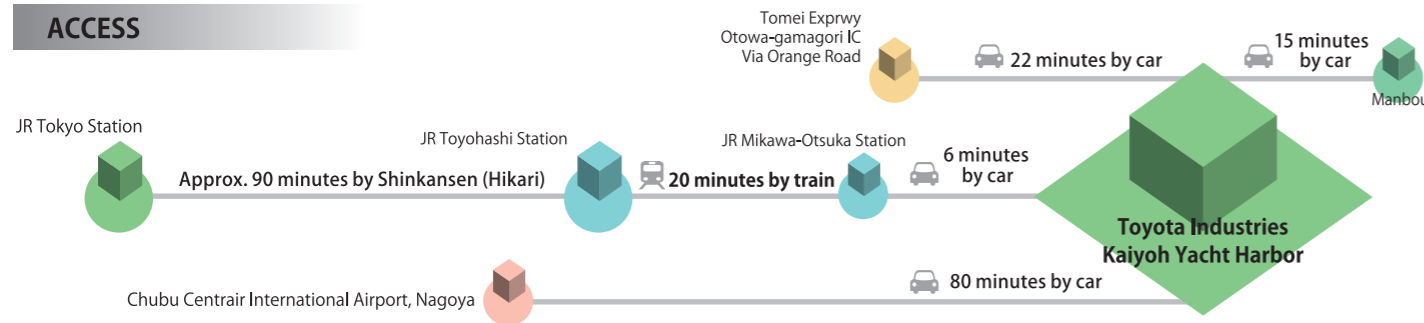

Address	1-7, Kaiyo-cho, Gamagori City, Aichi Prefecture	
Size and specifications	This training facility meets the requirement of National Federation of Sailing. Available vessel types: dinghy yachts, cruiser yachts	
Constructed (renovated)	1993 (2017)	
Parking spaces	243 cars	
Universal design	Sloped doorways, Braille blocks, Wheelchair-accessible restrooms, Restrooms for ostomates, Disabled parking spaces	
Website	<a href="http://www.aichi-koen.com/kaiyo/">http://www.aichi-koen.com/kaiyo/</a>	
Storage facilities	Boat yard: 18,059.62 m <sup>2</sup> Boathouse: 10,539.1 m <sup>2</sup>	New boathouse: 331.24 m <sup>2</sup>
Rental yachts	6 types, 50 vessels (Snipe, Sea Hopper, Laser, Laser II, Sikhara, RS Tera)	
Berthing facilities	4 floating piers (central floating pier: 62.0-meter x 2 places East floating pier: 80-meter x 1 place, west floating pier: 102.8-meter x 1 place) Boat lift yards (2, total length: 225.6 meters)	
Water supply equipments	31 units	
Clubhouses	16 conference rooms, Locker rooms (men's and women's 1 each, total of 232 lockers) Shower rooms (men's and women's 2 each, total of 33 shower units) Dispensary, Restaurant, Changing rooms (men's and women's 1 each)	
Load-handling equipment	Crane: 9-ton hoist, Boat carrier: 8-ton traction	

### ACCESS



### Accommodations in the vicinity

<ul style="list-style-type: none"> <li>Hen na Hotel Laguna Ten Bosch   100 rooms/300 people   1 minute on foot from the facility</li> <li>Gamagori Orange Pension   6 rooms/18 people   5 minutes by car from the facility   <a href="#">Miya Onsen</a></li> <li>Higaki Hotel   65 rooms/302 people   7 minutes by car from the facility   <a href="#">Miya Onsen</a></li> <li>Hiranoya   70 rooms/400 people   7 minutes by car from the facility   <a href="#">Miya Onsen</a></li> <li>Shofuen   103 rooms/500 people   8 minutes by car from the facility   <a href="#">Miya Onsen</a></li> <li>Hotel Meizanso   90 rooms/450 people   8 minutes by car from the facility   <a href="#">Miya Onsen</a></li> <li>Hotel Mikawa Kaiyoukaku   30 rooms/190 people   9 minutes by car from the facility   <a href="#">Miya Onsen</a></li> <li>Gamagori Hotel   111 rooms/225 people   11 minutes by car from the facility   <a href="#">Gamagori Onsen</a></li> <li>Gamagori Classic Hotel   27 rooms/60 people   14 minutes by car from the facility   <a href="#">Gamagori Onsen</a></li> <li>Hotel Takeshima   94 rooms/449 people   15 minutes by car from the facility   <a href="#">Gamagori Onsen</a></li> <li>Yamadakan   17 rooms/75 people   26 minutes by car from the facility   <a href="#">Katahara Onsen</a></li> <li>Suzuoka   50 rooms/250 people   26 minutes by car from the facility   <a href="#">Katahara Onsen</a></li> </ul>	<ul style="list-style-type: none"> <li>Katahara Resort Gamagori Hotel Annex   27 rooms/75 people   26 minutes by car from the facility   <a href="#">Katahara Onsen</a></li> <li>Shunuiso   12 rooms/40 people   26 minutes by car from the facility   <a href="#">Katahara Onsen</a></li> <li>Ten No Maru   37 rooms/186 people   27 minutes by car from the facility   <a href="#">Gamagori Onsen</a></li> <li>Nishiura Grand Hotel Kikkei   42 rooms/250 people   34 minutes by car from the facility   <a href="#">Nishiura Onsen</a></li> <li>Fujimisou   47 rooms/250 people   34 minutes by car from the facility   <a href="#">Nishiura Onsen</a></li> <li>Wa no Resort Hazu   45 rooms/250 people   35 minutes by car from the facility   <a href="#">Nishiura Onsen</a></li> <li>Shunkei Roman Gimpaso   60 rooms/330 people   35 minutes by car from the facility   <a href="#">Nishiura Onsen</a></li> <li>Tenku Kaiyu no Yado Suehiro   70 rooms/300 people   35 minutes by car from the facility   <a href="#">Nishiura Onsen</a></li> <li>Himeyado Hanakazashi * Women only   17 rooms/65 people   36 minutes by car from the facility   <a href="#">Nishiura Onsen</a></li> <li>Tatsuki (Hotel Tatsuki)   73 rooms/450 people   36 minutes by car from the facility   <a href="#">Nishiura Onsen</a></li> <li>Hotel Toukaien   82 rooms/550 people   36 minutes by car from the facility   <a href="#">Nishiura Onsen</a></li> </ul>
--	--

Inquiries regarding the accommodations above: Gamagori City Tourist Association  
**TEL** +81-533-68-2526 (Only Japanese available) **URL** <http://gamagori.jp>

Sports Division, Board of Education, Gamagori City **TEL** +81-533-66-1222 Office hours: 8:30 a.m. – 5:15 p.m. \* Except Tuesday and Dec. 29 through Jan. 3 \* Only Japanese available. **E-Mail** [sports@city.gamagori.lg.jp](mailto:sports@city.gamagori.lg.jp) \* English acceptable

Kaiyoh Yacht Harbor Aichi Urban Development Association **TEL** +81-52-951-1430 Office hours: 8:00 a.m. – 5:00 p.m. (Change depending on the season) \* Except Wednesday and Dec. 29 through Jan. 3 \* Only Japanese available.

Information on the sports facilities in Aichi Aichi Sports Commission <http://aichi-sc.jp/>

\*The information listed on this leaflet is as of October, 2017, and is subject to change without notice.

A rich record of international competitions, including the Sailing World Cup. Many nearby accommodations.

# Toyota Industries Kaiyoh Yacht Harbor



■ Gamagori City, Aichi Prefecture

Pre-game training camp/Suggested Sports

Sailing

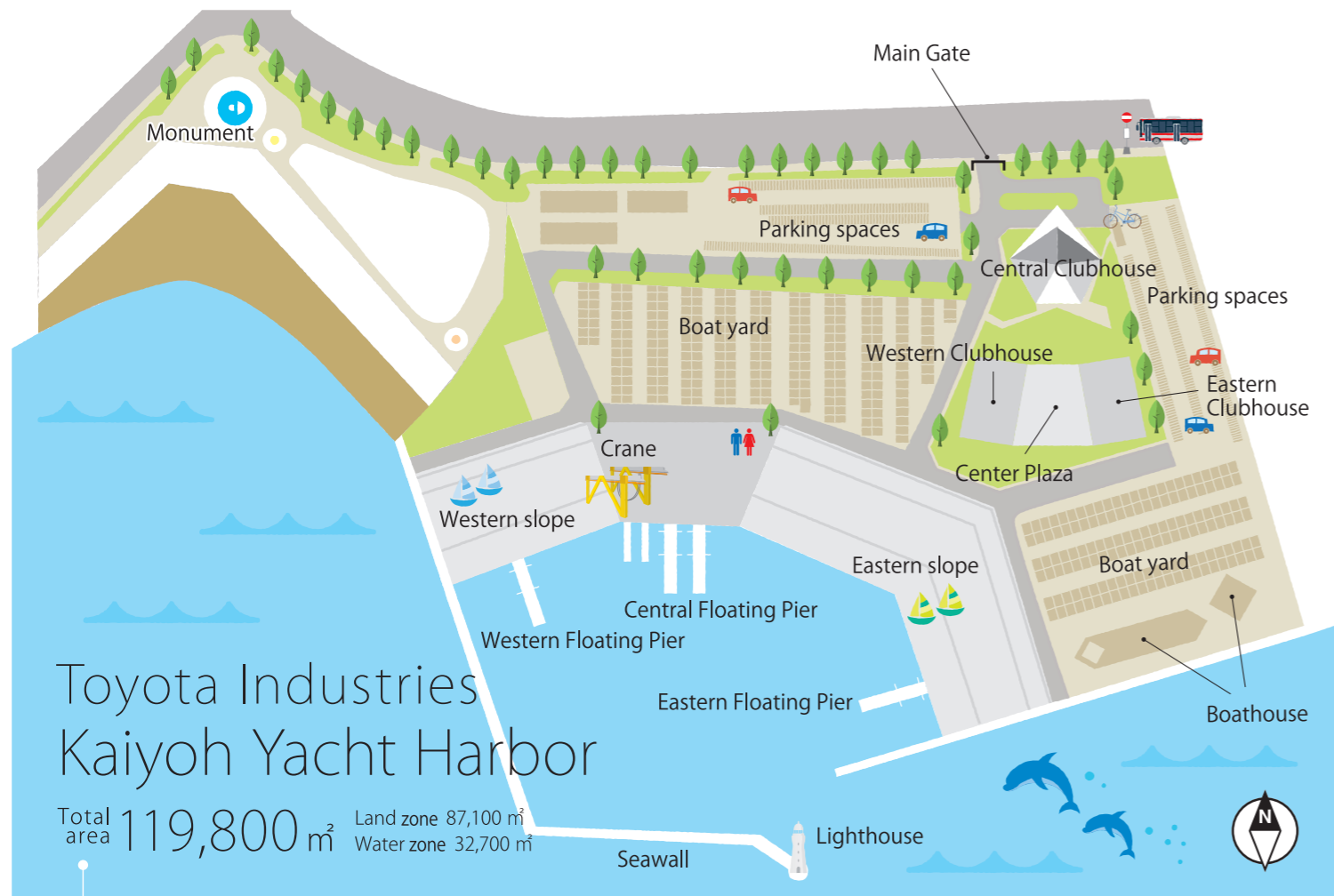

- This training facility meets the requirement of National Federation of Sailing.
- Land zone storage capacity: 559 boats
- Open freight space (Outdoor: 14,000 m<sup>2</sup>, Indoor: 4,000 m<sup>2</sup> (including temporary space))



Boathouse (right: 1,053.91 m<sup>2</sup>, left: 331.24 m<sup>2</sup>)



Boat carrier (8-ton traction)



Slopes (2 slopes, total length 225.6 meters)



Crane (9-ton hoist)

### Major international competitions held

Jul. 1994 Snipe Class World Masters Championship  
 Jul. 2005 Snipe World Championship  
 World Exposition, Aichi Partnership Project

Jul. 2016 Test Event for 2017 Gamagori Tasar World Championship  
 Aug. 2017 Tasar World Championship 2017  
 Oct. 2017 Sailing World Cup

## Toyota Industries Kaiyoh Yacht Harbor

This is one of the few facilities in Japan where international competitions can be held, and the east and west boat lift yards boast a capacity of the largest class in Japan. Construction in 2017 added clubhouses, a boathouse, and floating piers.

### Central clubhouse

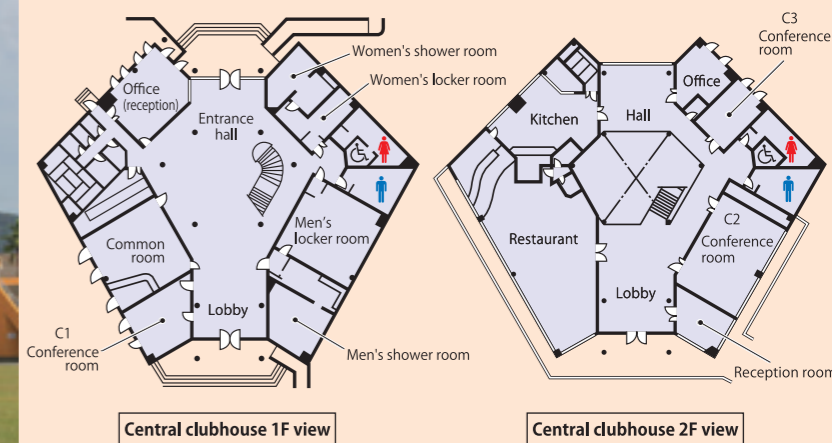

### Center plaza and western and eastern clubhouses

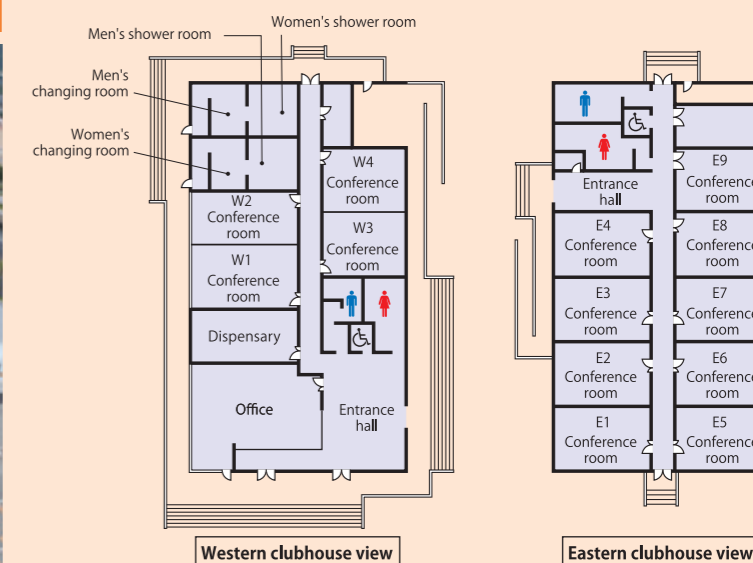

15 minutes by car from Kaiyoh Yacht Harbor (5.0 km)

### Wheelchair accessible ramp Manbou

- First wheelchair accessible pontoon in Japan
- The bridge connecting the floating pier and the land is moderately sloped and anti-slip paved.
- The landing pier is equipped with a lifter to assist the disabled with boarding.
- To the floating pier (5 m wide, 24 m long), three yachts or motor boats can be moored.